



- Founded 1990, currently 20 employees
- Offices in Hamburg, Lübeck, Kiel and Munich

- 75 completed projects and
- 20 project under development
- Project size 3 to 130 units
- 2.200 residential units
- 180 commercial units
- 200.000 sqm
- Total sum: 550 Mio Euro
- 30% cooperatives and associations
- 70% private property



# Work focus Conplan

- WE WORK WITH PEOPLE
- Moderation of process
- especially towards members of the project
- Take care of all contracts
- Take care of purchasing property and financing
- Take care of calculation
- Guide all designers / companies
- Booking and paying
- Middle of all conflicts

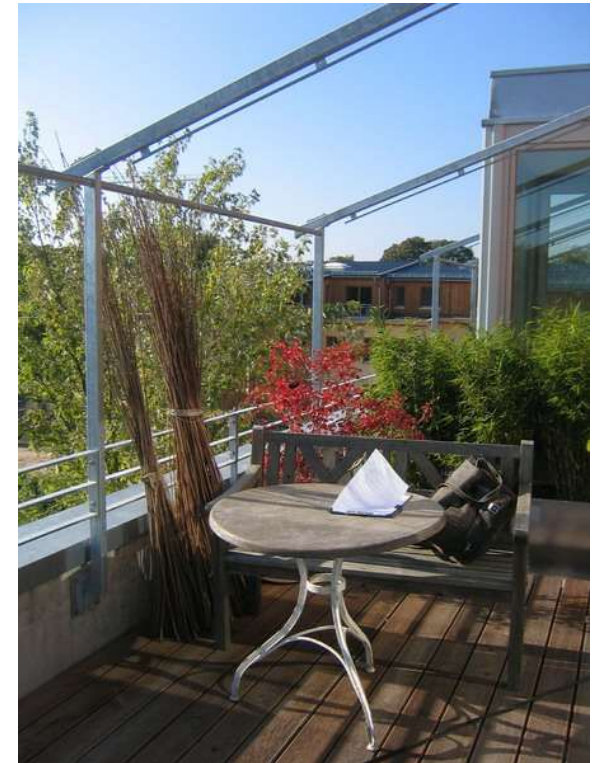

# Community projects

## community project

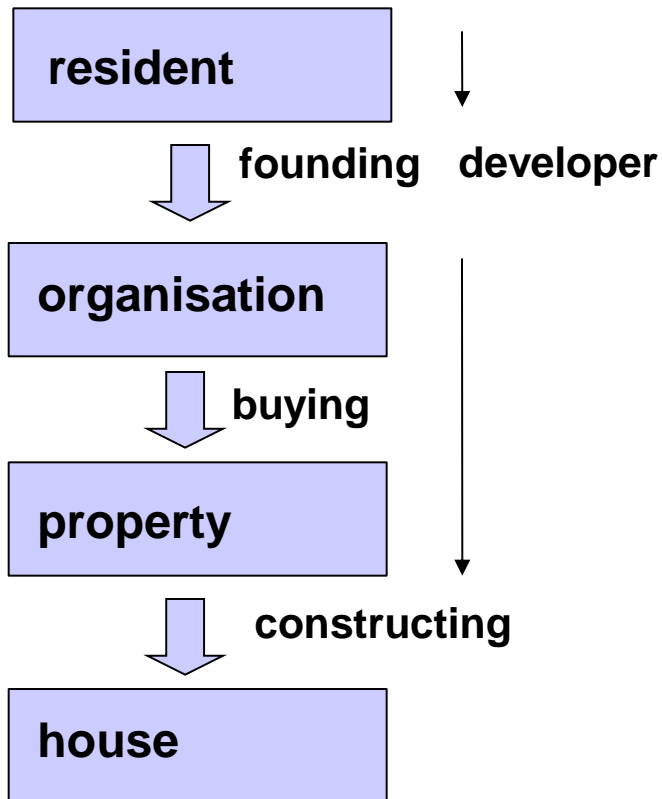

## Investment project

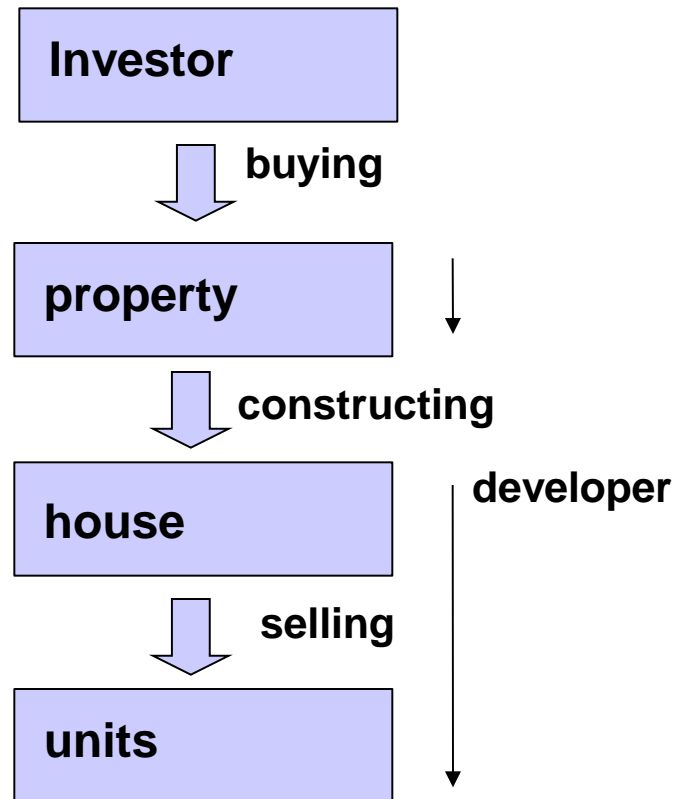

# Advantage of community projects

- People take part in designing process (own floor plans)
- But also in design of community spaces and outdoor installation
- Social topics (e.g. integration of disabled person, refugees)
- You can bring in your own work
- Neighbourhood / community aspects are important
- Low cost / no speculation

Dock 71 (Hafencity) ends up with 3.600 Euro / sqm > an investor would sell it for 7.000-8.000 Euro / sqm

# Spatzenhof Curau (“sparrow” “yard”)

Siteplan, partly sheds and farm houses



## Key facts

- 22 housing units in old sheds and farmhouses
- Stockelsdorf close to Lübeck
- Whole food shop, guest apartment
- Biological farm
- Privat property
- Total cost: 3,6 Mio Euro
- Ecological construction material, low energy standard, use of rainwater
- Cultural monument
- Mixture of generations



## Progress

- Request of estate owner
- Initiative of Conplan to start the project (one year)
- Benefit of Schleswig Holstein (15.000 Euro to start the project)
- After one year 7 housing units in three buildings were renovated / constructed
- After 15 months another 11 units were constructed
- Biological farm was always part of the running project





# Rural projects need...

- An exceptional landscape
- Special, charismatic buildings
- Good ideas
- Strong initiatives
- A good connection to schools, doctors, shops, etc

# Spatzenhof Curau



# Spatzenhof Curau



# Spatzenhof Curau



# Spatzenhof Curau



# Spatzenhof Curau



# Spatzenhof Curau



# Spatzenhof Curau







# Gut Brandenbaum



# Gut Brandenbaum



# Gut Brandenbaum



# Palingen



# Palingen



# Allmende Wulfsdorf

- 7.000 sqm housing, 4.000 sqm commercial
- cost ca. 25 Mio Euro
- Mainly private property, 18 units for rent
- eight housing units for disabled persons
- Workshop for disabled persons
- 15 working units for artists
- Alternative health centre
- Kindergarten
- ....

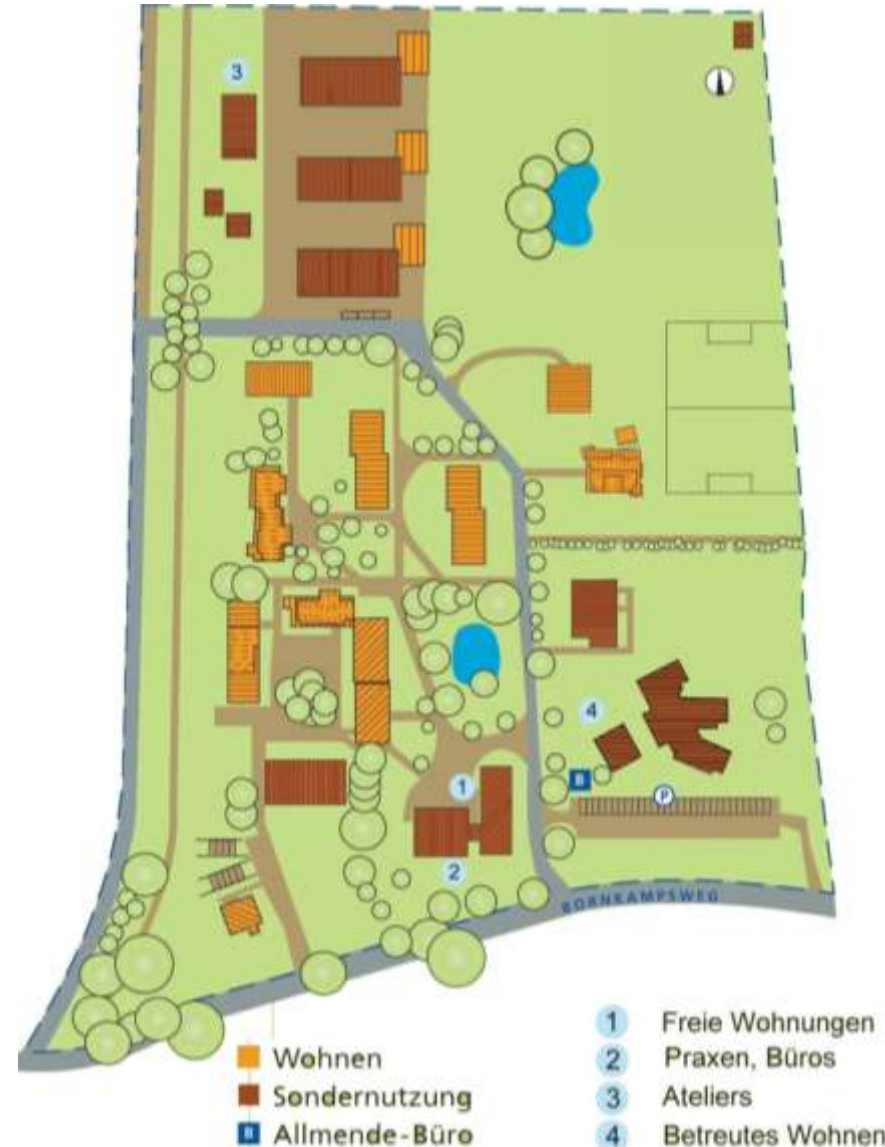

## Community spaces

- gym
- Community room
- Seminar room
- Room for the youth
- Several playgrounds
- Soccer field
- Swimming pond with beach
- Community gardes
- Club that organises all community activities





# Allmende Wulfsdorf



# Allmende Wulfsdorf



# Allmende Wulfsdorf



# Allmende Wulfsdorf



# Allmende Wulfsdorf



# Allmende Wulfsdorf



# Allmende Wulfsdorf



# Allmende Wulfsdorf





# Allmende Wulfsdorf

COMPLAN  
PROJEKTBERATUNG



# Allmende Wulfsdorf



# Allmende Wulfsdorf

COMPLAN  
PROJEKTBERATUNG







# Allmende Wulfsdorf



# Allmende Wulfsdorf



# Wilde Rosen

- 68 housing units
- 27 Mio Euro
- 7.500 sqm living 3.500 sqm commercial
- Mainly private property
- 24 housing units for disabled persons
- Integration café for disabled
- Offices, working and living
- Conference centre





## community

- Community room 130 qm
- Apartment for guests
- Community gardens, heating by wood pellet
- Village square with stage
- playgrounds
- Soccerfield, table tennis
- Kids room, artists space
- horses
- Carsharing mit 6 cars (2 electro cars)
- Club that organises all community activities



Sommerfestival, Kinderfest, Osterfest, Sylvesterparty, Fasching, Weihnachtssingen, Kino, Yoga, Gemeinschaftsworkshops, Flohmarkt, Tauschring, etc

# Wilde Rosen



# Wilde Rosen



# Wilde Rosen



# Wilde Rosen



# Wilde Rosen



# Wilde Rosen



# Wilde Rosen (Seminarhaus)





# Wilde Rosen (conference centre)



# Wilde Rosen (integration Cafe)



# Wilde Rosen (integration Cafe)



# Wilde Rosen (Gemeinschaftsraum)



# Wilde Rosen (Suma)



# Wilde Rosen (summer festival)



# Wilde Rosen (summer festival)



# Wilde Rosen (self-help)





# Wilde Rosen



# Aegidienhof Lübeck

- 52 housing units, 10 commercial units
- 12 Mio Euro
- Private property
- Integration cafe
- 2002
- Monument conversation



# Aegidienhof Lübeck



# Aegidienhof Lübeck



# Aegidienhof Lübeck



# Aegidienhof Lübeck



# Aegidienhof Lübeck



# Aegidienhof Lübeck





# Aegidienhof Lübeck

COMPLAN  
PROJEKTBERATUNG



# Hamburg / Wilhelmsburg



# Hamburg / Wilhelmsburg



# Hamburg / Wilhelmsburg





tilsammans, Hamburg

COMPLAN  
PROJEKTBERATUNG



tilsammans, Hamburg

COMPLAN  
PROJEKTBERATUNG



# Dock 71 GbR, Hafencity





# Dock 71 GbR, Hafencity

- 58 housing units
- 29 Mio Euro
- 6.200 sqm housing, 1.800 sqm commercial
- Privat property
- Kita, Café, offices
- Ca. 3.100 – 3.600 Euro / qm
- Finished In 2016
- Started in 2009
- 50% car-free
- Part of a bigger project with two cooperatives as partners, partly with government funded housing



## community

- Community room 70 sqm
- Own car-sharing
- Roof terrace with community garden, private garden and a party container
- Community courtyard
- bicycle workshop
- Taking part on a special management of the district



# Dock 71 GbR, Hafencity



# Dock 71 GbR, Hafencity



# Dock 71 GbR, Hafencity



# Munich, Prinz Eugen Park

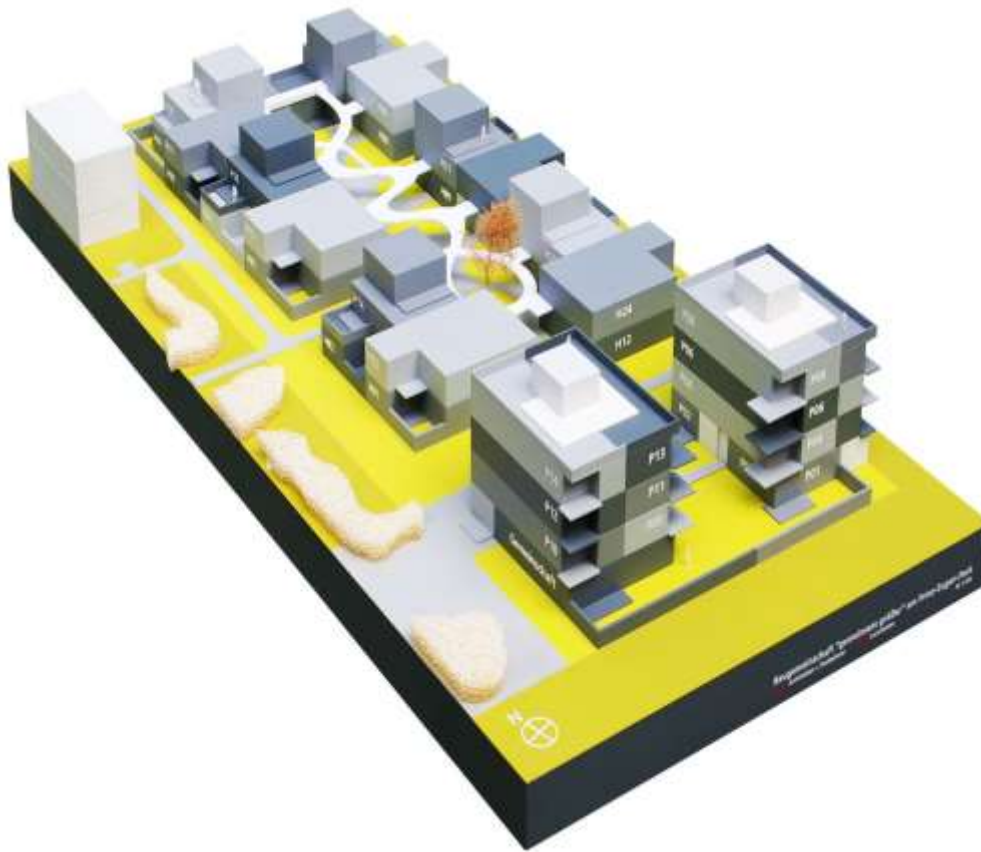

- › Four community projects
- › Alle buildings are made of wood
- › 13 different community spaces (815 sqm)
- › Community rooms, apartments, exhibition, music, cinema/theatre, workshops, café, bar, marketplace, ...

# Munich, Prinz Eugen Park



# Munich, Prinz Eugen Park

